

Model: BF05

材质: 128克铜板纸,单色印刷

展开尺寸: 240x170mm

成型尺寸: 120x170mm

装订工艺: 骑马订

20251028

LNDU

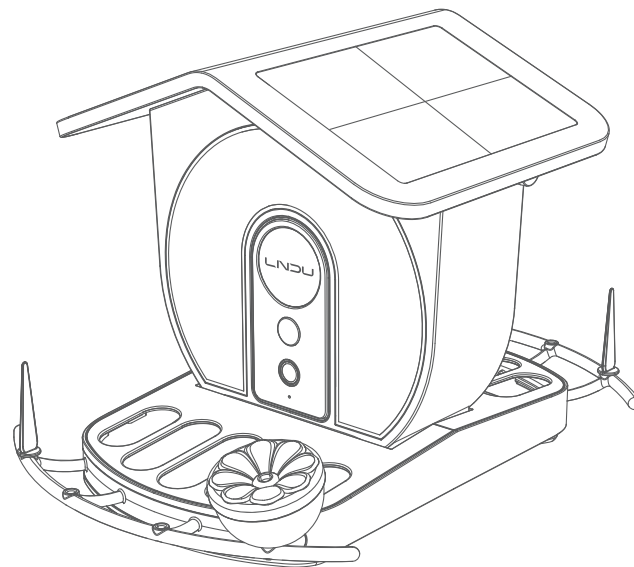

Customer Service

· Call Us

United States +1(844) 820 5077

Monday to Friday: 9:00 AM - 9:00 PM(PT)

Saturday and Sunday: 9:00 AM - 6:00 PM(PT)

· Email Us

Support: LNDU@Indu.com

Shenzhen Lingdu Auto Electronics Co., Ltd.

F28/29 Tower A Lechuanghui Building, No.1211Guanguang

Road, Longhua District, Shenzhen, China

User Manual

LNDU Smart Bird Feeder with Dual-Camera

Model: BF05

Contents

1. Hardware introduction.....	01
2. Parts List.....	04
3. Installation Bird Feeder.....	05
4. How To add bird food?	09
5. Add Device.....	10
6. Battery recharge.....	14
7. FAQ	14

1 / Hardware introduction

Overview

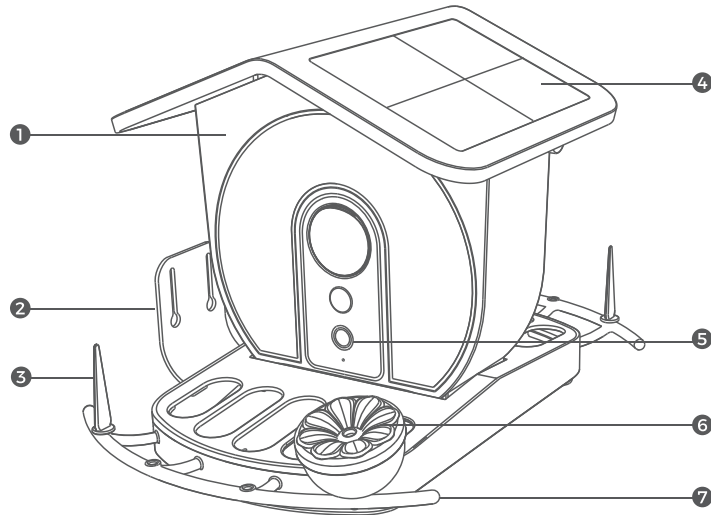

- ① Feeding Hoppers
- ② Wall Mount
- ③ Fruit Holder
- ④ Solar panel
- ⑤ Bird feeder Camera
- ⑥ HummingbirdFeeder
- ⑦ bird stand

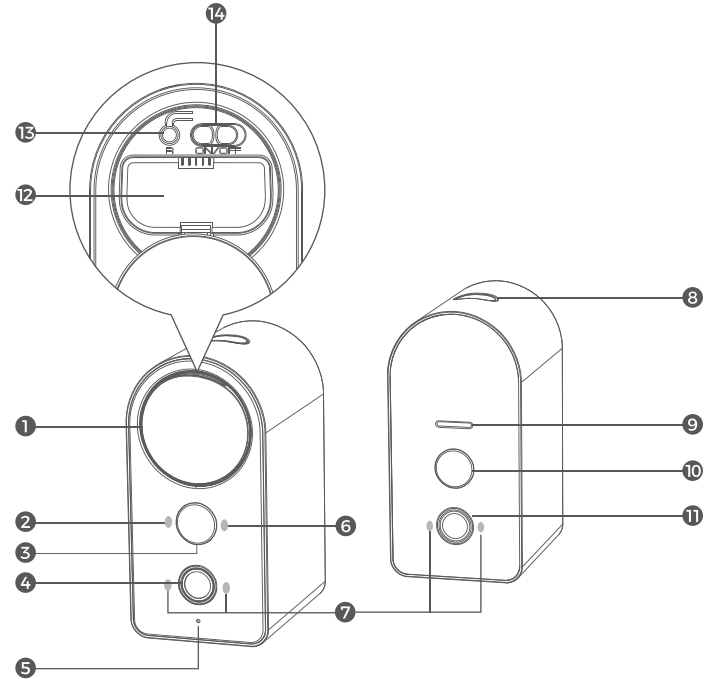

- ① Battery Cover
- ② Operating Staius indicator Light
- ③ PIR1(movtion sensor)
- ④ Camera lens 1
- ⑤ MIC phone
- ⑥ Charging Status Indicator light
- ⑦ Infrared night vision LED
- ⑧ Power input. Solar charging
- ⑨ Speaker
- ⑩ PIR2 (movtion sensor)
- ⑪ Camera lens 2
- ⑫ Lithium-ion Battery
- ⑬ Reset Button
- ⑭ POWER ON/OFF

Status and Indicator

Device Status	Charging Status indicator Status	Operating Status indicator Status	Trigger Action
Turn on	/	/	Toggle the switch to ON
Turn off	/	/	Toggle the switch to OFF
waiting for the WiFi	/	Red light blinks slowly	long press Reset Button for 5S
Connecting to the WiFi	/	Green light blinks slowly	/
Connect to the WiFi Successful	/	Green light is always on	/
Connect to the WiFi Failed	/	Red light blinks slowly	/
WiFi offline status	/	Red light blinks slowly	/
Firmware OTA Upgrading	/	Green light blinks rapidly	APP
Remove device/ restore factory settings	/	Red and green traffic lights flash alternately and slowly →Red light blinks slowly	APP/ Long press Reset Button for 5S
Standby state	/	All light is off	/
Battery Charging	white light is always on	/	/
Battery Charged	white light is off	/	/

2 / Parts List



Camera
x 1



Lithium-ion battery
x 1



Feeding Hoppers
x 1



Solar Panel
x 1

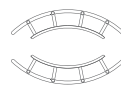

Bird stand
x 1



Bird feeding Area
x 1



HummingbirdFeeder
x 1



Fruit Holder
x 1



Metal bracket
x 2



Metal hose clamps
x 4



Fittings Bag
x 1



Screwdriver
x 1



Wall Plug & Screw
x 2



Bracket positioning
sticker x 1



User manual
x 1

3 / Installation Bird Feeder

Option 1. Mount the Bird Feeder Camera to Wall

1. Use the provided drilling template to mark the hole locations on the wall.
Use a drill bit to drill two holes.

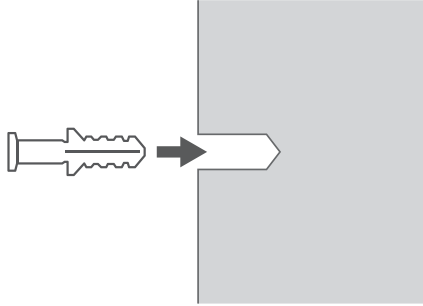

2. Use the provided screws to install the bird feeder bracket onto the wall.

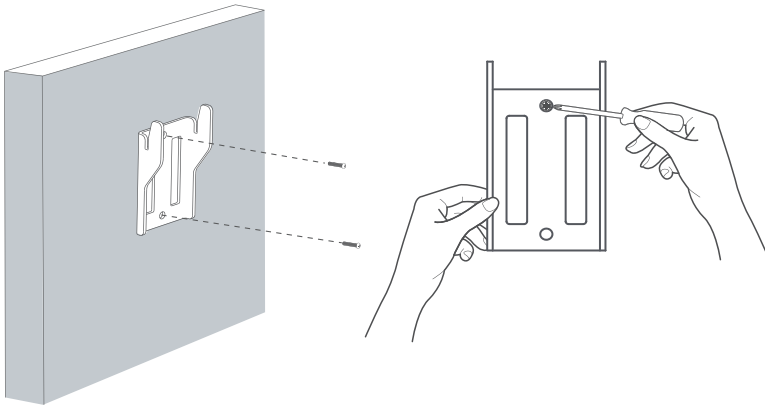

05

3. Hang the bird feeder on the securely mounted bracket.

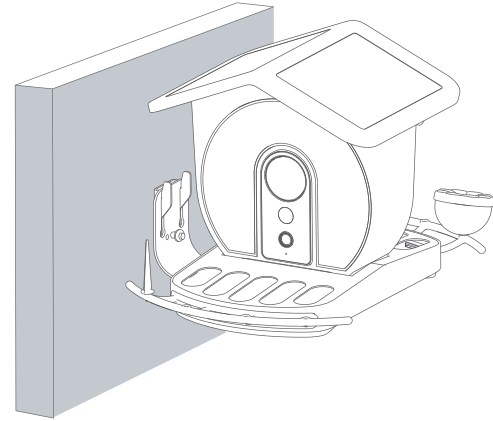

Option 2. Mount the Bird Feeder Camera to Tree

1. Wrap the mounting bracket around the tree using straps.

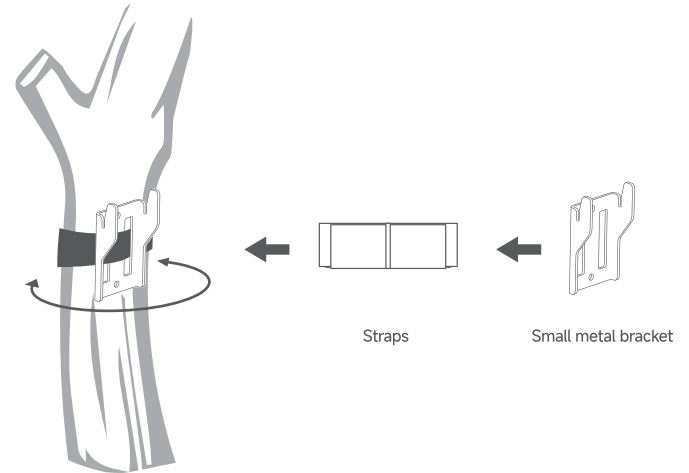

06

Step2: Then hang the assembled bird feeder with Dual-camera on the small metal bracket.

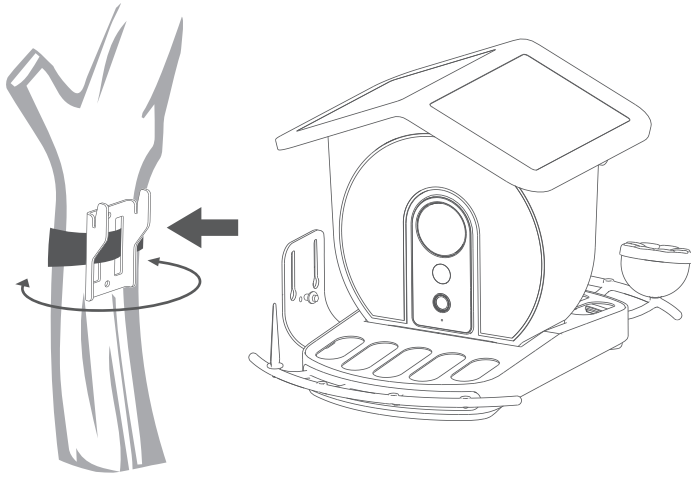

2. Secure the bracket to the pole using a clamp.

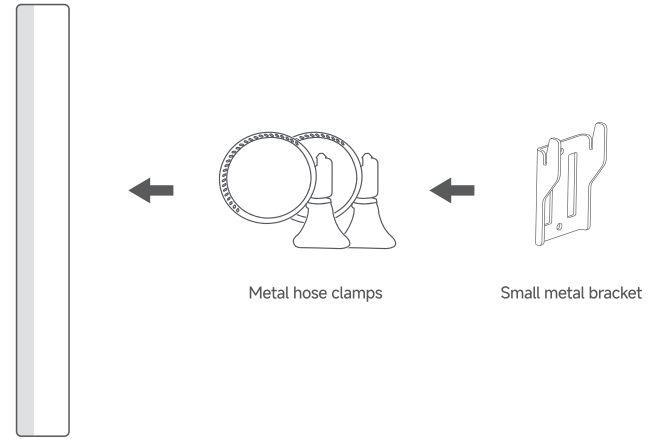

3. Hang the bird feeder on the securely mounted bracket.

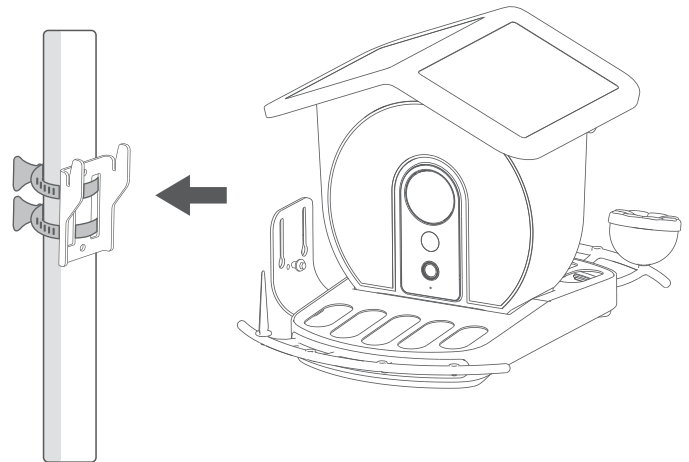

Option 3. Mount the Bird Feeder with Dual-camera to Pole

1. Select a metal hose clamps of the appropriate size.

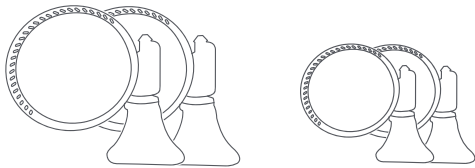

4/ How To add bird food?

Step 1: Open the clasp on the front of the Bird Feeder Camera and pull up towards the roof to open it.

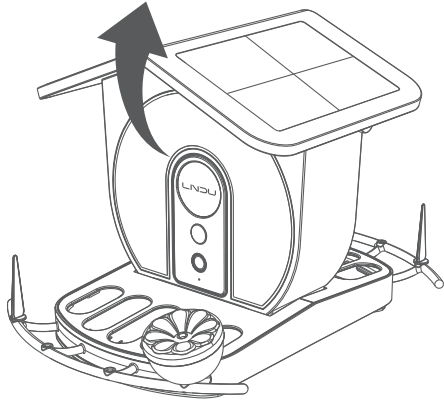

Step 2: You can add bird food. Finally, rotate the roof back into place and press the clasp down to secure it.

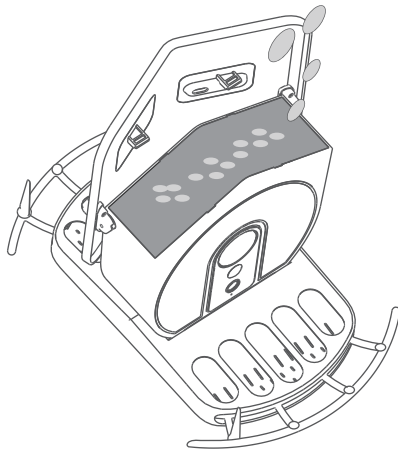

5/ Add Device

Step1. Download LNDU APP

Please use your mobile phone to scan the QR code below.



Download the app to discover all functions
If any questions, please email to LNDU@lndu.com
or Feedback in the LNDU App



Installation_guide



Pairing_setup_guide



Operation_guide



Clean_guide

Battery Charging

Notice: Please charge the battery before use.

Step2. Registration and Login



step1. App Startup

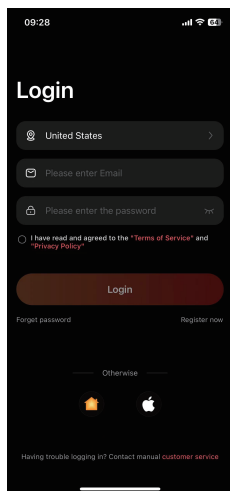

step2. App Login Page

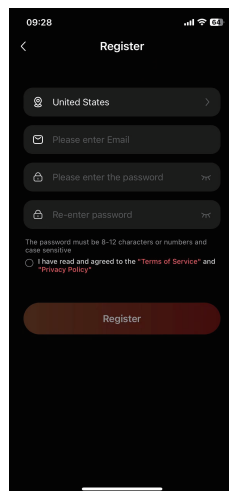

step3. App Registration Page

Step3. Device Status Check

1. Install Batteries

2. Check if the device's red light is blinking (For initial setup, the app will discover the device automatically).

3. If it's not the first setup, press and hold the reset button for 5 seconds to enter pairing mode.

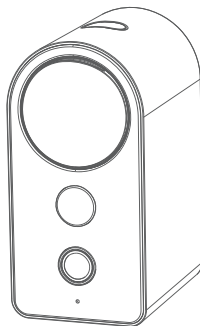

Step4. Add Device

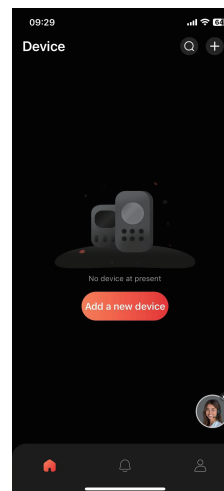

step1. On the home page, tap "Add a new device" or "+" to go to the product category selection page.

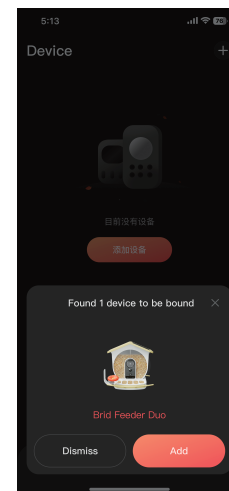

If the device is automatically discovered by the APP, jump directly to step5

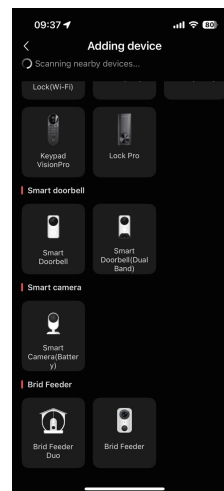

step2. Select Bird Feeder Type: Bird Feeder Duo

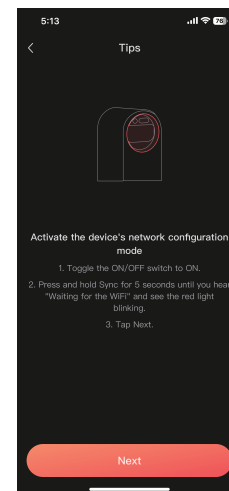

step3. Proceed to Network Setup Instructions

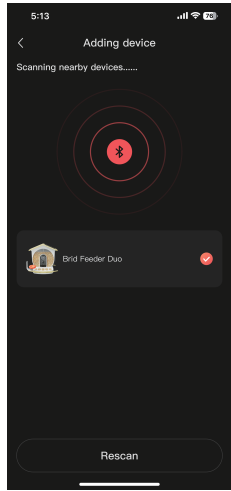

step4. Device found. Tap to add.

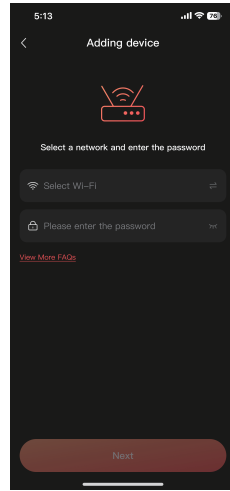

step5. Enter WiFi Name and Password

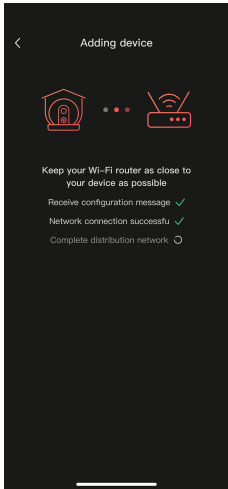

step6. Device Connecting

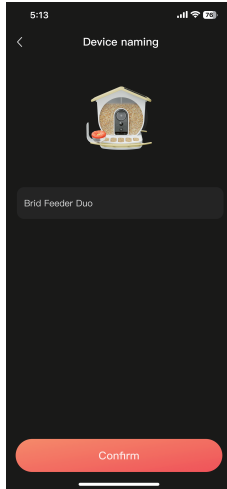

step7. Device successfully set up. Proceed to the naming page.

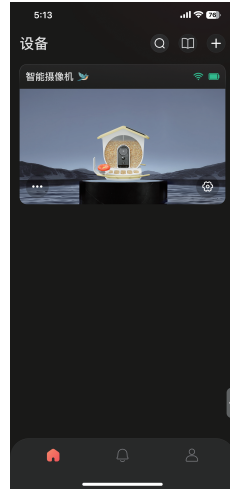

step8. Device named successfully. Returning to the homepage where the device card is now displayed.

6/ Battery recharge

If the battery level is below 20%, the APP will send a low-battery notification. Please charge it in a timely manner.

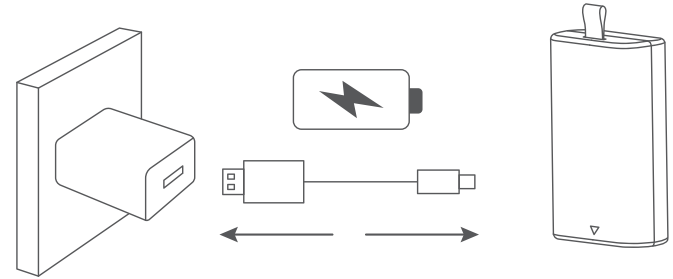

7/ Smart Binocular Birdwatcher - FAQ

Q1: What video resolutions and encoding formats does the birdwatcher support?

A: The device supports 1080P@50fps high-definition video recording. Video encoding formats include H.264 / H.265, and the file format is MP4, which ensures smooth playback on most devices.

Q2: Does the birdwatcher support both 2.4GHz and 5GHz Wi-Fi?

A: Yes. The device is compatible with dual-band Wi-Fi (2.4GHz & 5GHz) and can automatically or manually select the optimal frequency based on the network environment to ensure stable transmission and performance.

Q3: Why is the charging speed slow?

A: If charging becomes slower than usual, possible causes include:

1. The solar panel is not facing direct sunlight;
2. Dust, leaves, or bird droppings are covering the solar panel;
3. Cloudy or rainy weather reduces sunlight intensity;
4. A non-original cable or power adapter is being used.

Optimization Tips:

1. Install the solar panel in a sunny, unobstructed location;
2. Clean the solar panel regularly to remove dust and debris;
3. Adjust the panel angle to face the sun directly;
4. Avoid powering multiple high-consumption accessories simultaneously.

Q4: What should I do if the device is not used for a long time?

A:

1. Fully charge the device before storage;
2. Store it in a cool, dry place away from heat and humidity;
3. Recharge every three months to maintain battery health;
4. Before reuse, check that the lens and solar panel are clean to ensure proper operation.

FCC Statement

This equipment has been tested and found to comply with the limits for a Class B digital device, pursuant to part 15 of the FCC Rules. These limits are designed to provide reasonable protection against harmful interference in a residential installation. This equipment generates, uses and can radiate radio frequency energy and, if not installed and used in accordance with the instructions, may cause harmful interference to radio communications. However, there is no guarantee that interference will not occur in a particular installation. If this equipment does cause harmful interference to radio or television reception, which can be determined by turning the equipment off and on, the user is encouraged to try to correct the interference by one or more of the following measures:

- Reorient or relocate the receiving antenna.
- Increase the separation between the equipment and receiver.
- Connect the equipment into an outlet on a circuit different from that to which the receiver is connected.
- Consult the dealer or an experienced radio/TV technician for help.

Caution: Any changes or modifications to this device not explicitly approved by manufacturer could void your authority to operate this equipment.

This device complies with part 15 of the FCC Rules. Operation is subject to the following two conditions: (1) This device may not cause harmful interference, and (2) this device must accept any interference received, including interference that may cause undesired operation.

RF Exposure Information

This equipment complies with FCC radiation exposure limits set forth for an uncontrolled environment. This equipment should be installed and operated with minimum distance 20cm between the radiator and your body.